

NECK FINISH	"T"	"E"	"H"	"L"	"S"	"I"	HELIX ANG.	CUTTER DIA.	T.P.I	PITCH	THREAD TURNS
M28 SP415	1.078 ±.010	.984 ±.010	1.084 ±.015	.614MIN	.046 ±.015	.862	2°57'	.500	6	.167	2

NO.	REV. BY	DESCRIPTION	DATE

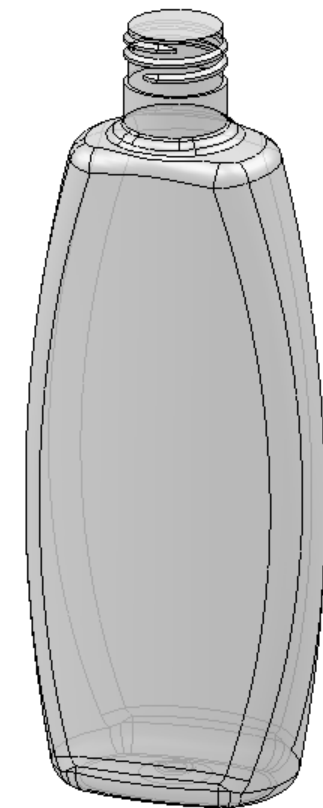

RECYCLING LOGO

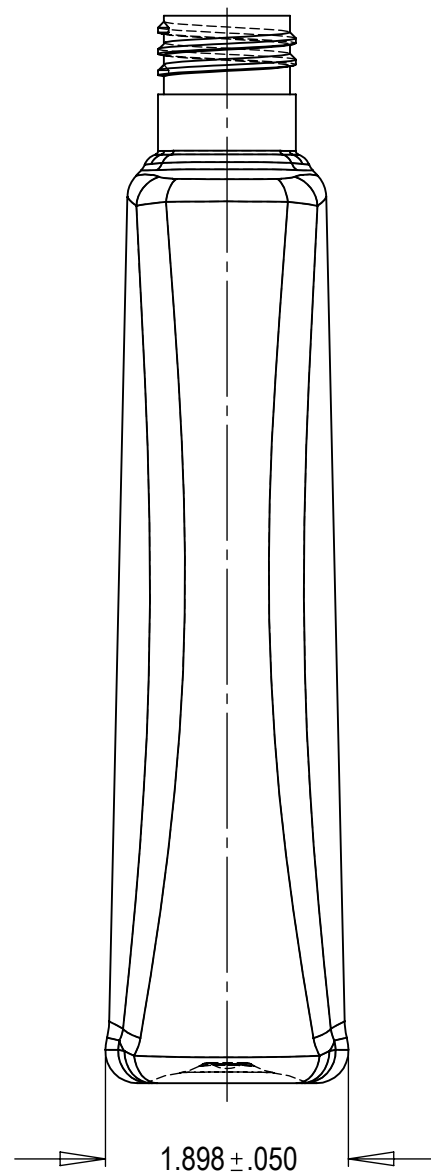
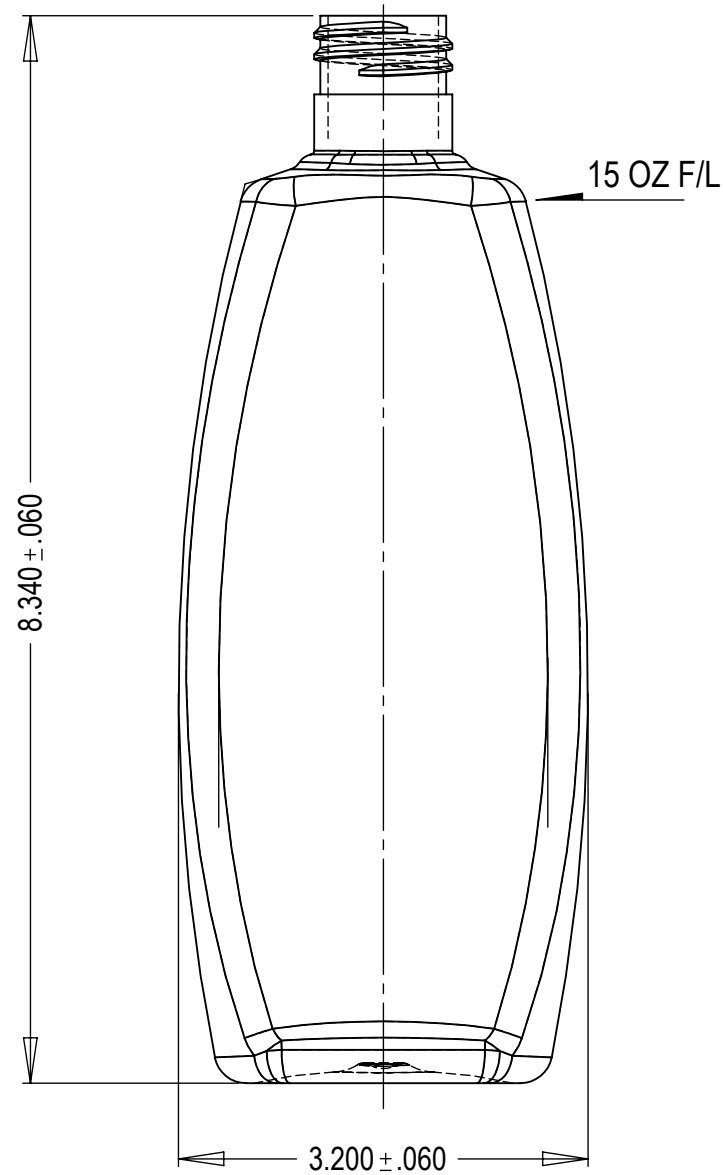
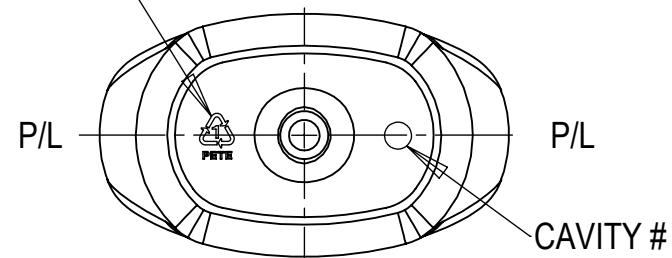

NOTE:

1. SKU# 100063, CLEAR.

THIS DRAWING CONTAINS PROPRIETARY INFORMATION OF CONSUMERS PACKAGING GROUP INC. NEITHER THIS DRAWING OR ITS CONTENTS MAY BE REPRODUCED IN ANY FORM, FOR ANY PURPOSE, UNLESS WRITTEN CONSENT IS GIVEN BY CONSUMERS PACKAGING GROUP INC.

BOTTLE SPECIFICATIONS			
MATERIAL: PETE	FILL CAPACITY:	444ML ± 11ML	
WEIGHT: 31g ± 1g	OVERFLOW CAPACITY:	475ML ± 11ML	
DWN. BY: Y.F.	DATE: 27/04/09	DESCRIPTION:	15 OZ BABY SHAMPOO
APR. BY:	DATE:	DRAWING NO:	CPG-1075-A-V01-R01
SCALE: 1:1.5			



Ocean State Packaging
(401) 884-4400