

NECK FINISH	BOTTLE WEIGHT (± 2.5 GR)	OVERFLOW CAPACITY (± 15.0CC)	"T" DIA	"E" DIA	"H" DIM	"S" DIM	"I" DIA	MATERIAL
38-400	52.0	831.9	1.476 1.452	1.382 1.368	.418 .388	.061 .031	.987 MIN	HDPE

DATE	SYM	REVISION RECORD	AUTH	DR	CK
7/15/13	A	INCREASED OVERALL HEIGHT REMOVED BEAD ON NECK REDUCED DEPTH OVERFLOW CAP WAS 811.9 LOWERED FILL LINE			
7/15/13	B	DECREASED LABEL HEIGHT INCREASED TOP & BOTTOM BUMPER			KSN

NOTES:

"M" STYLE THREAD
6 THREADS PER INCH
.167 PITCH
ONE FULL TURN OF THREAD

OVERFLOW CAPACITY IS BEFORE DECO

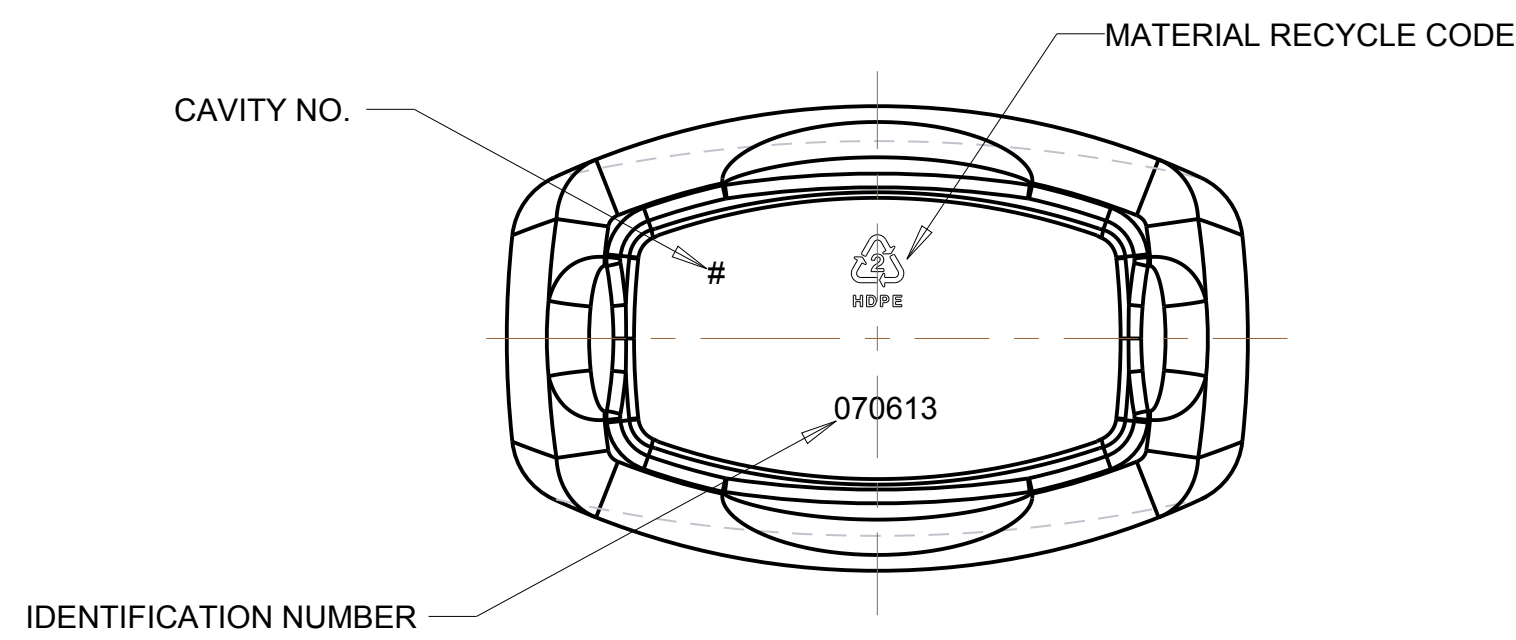
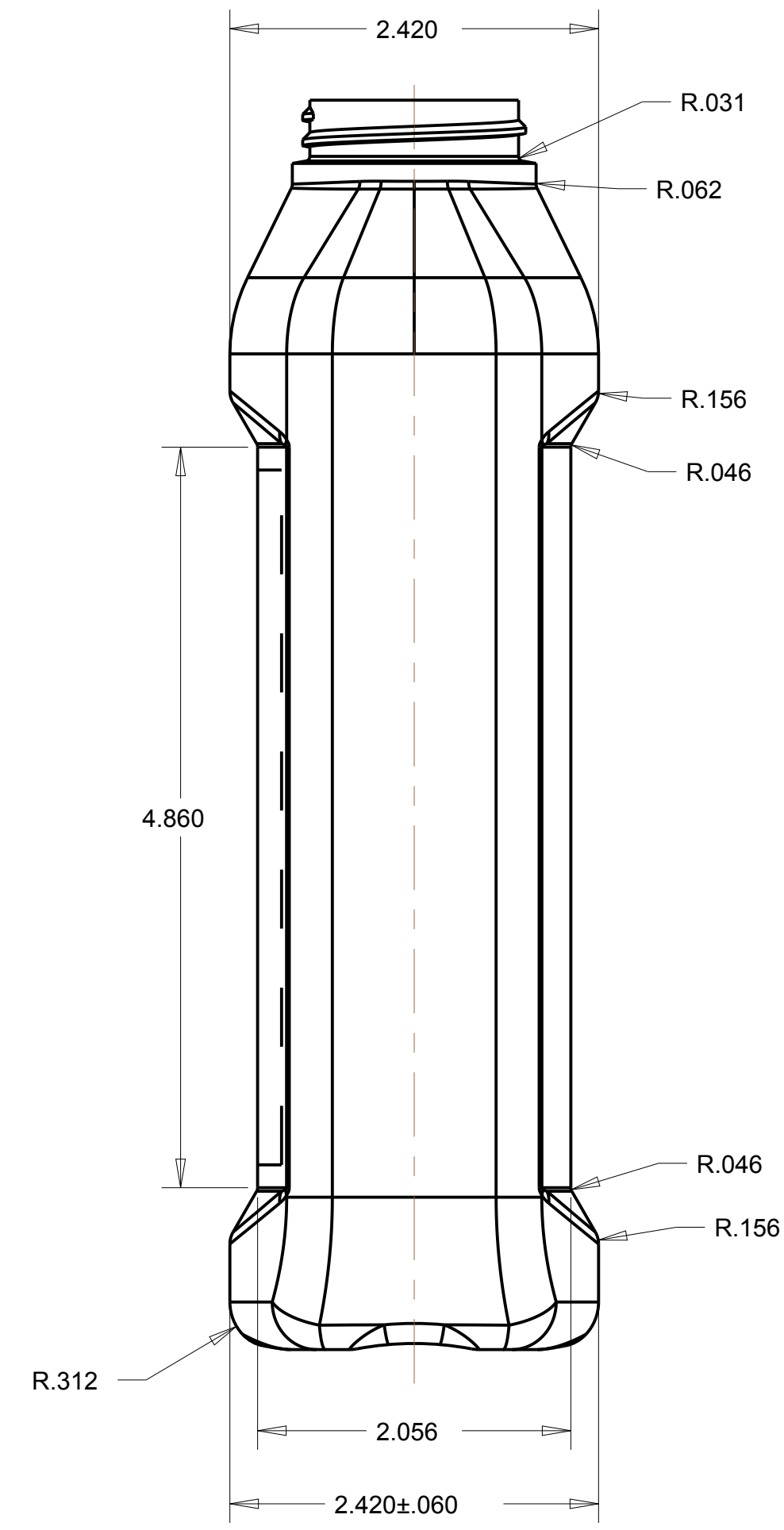
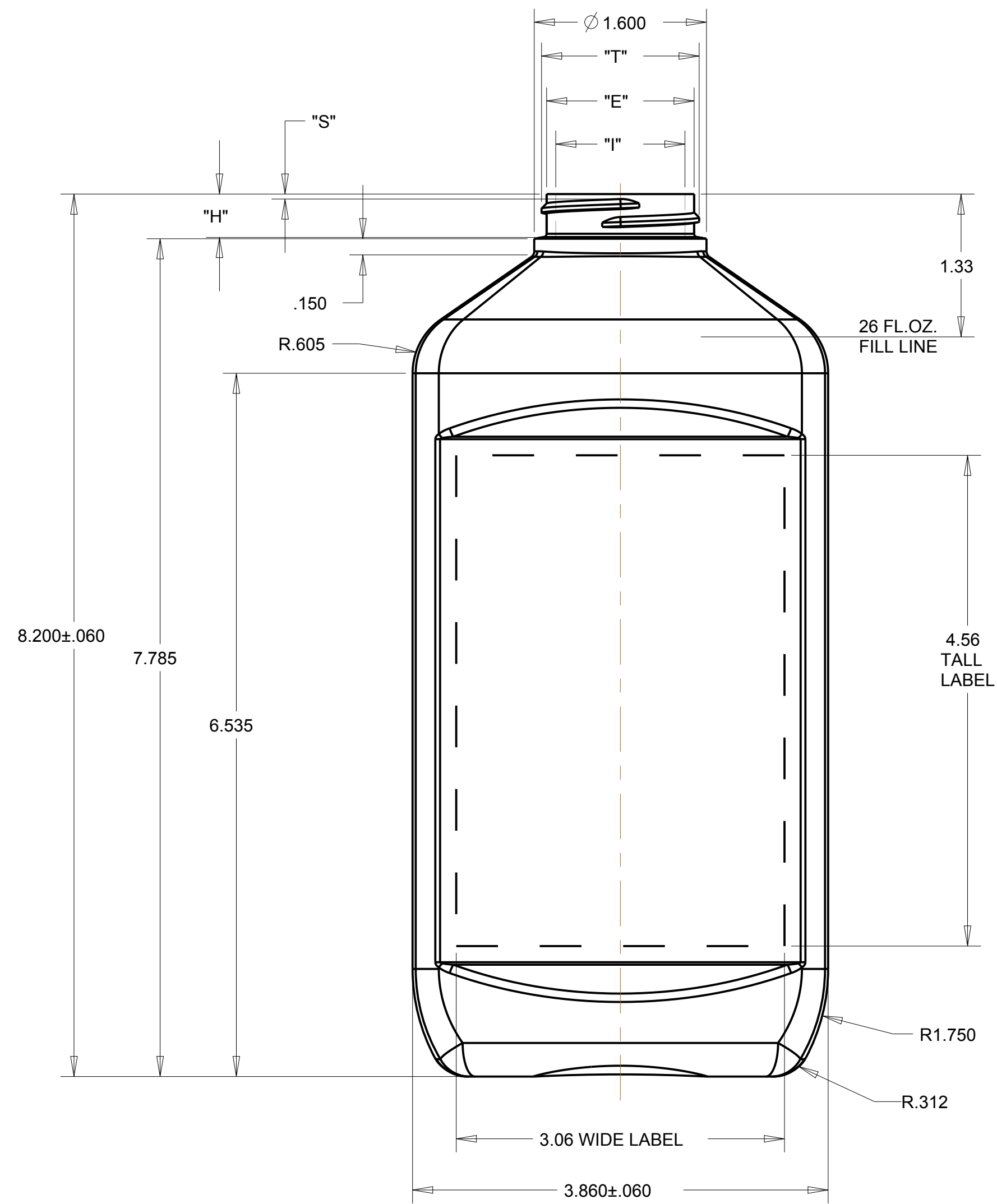
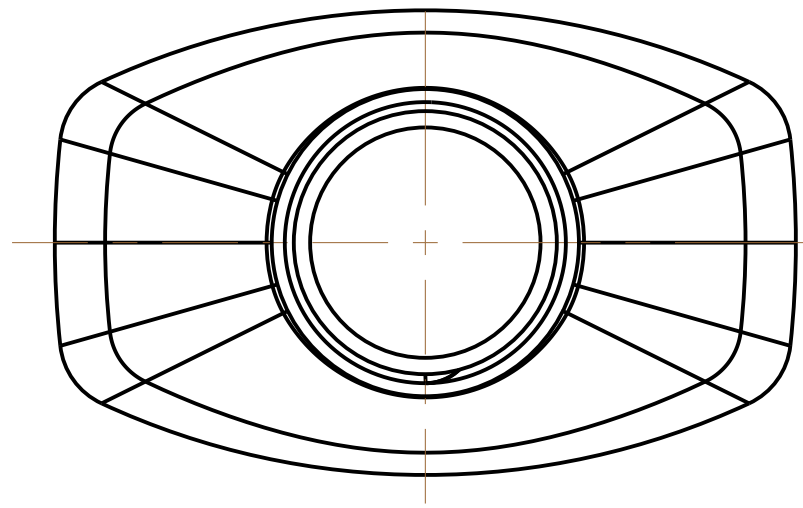

TOLERANCES (EXCEPT AS NOTED)				OCEAN STATE PACKAGING EXTRUSION AND INJECTION BLOW MOLDED BOTTLES	
DECIMAL	MATERIAL	SCALE	DRAWN BY		
FRACTIONAL	TITLE	APPROVED BY		MOLD NO.	
ANGULAR	DATE	DRAWING NUMBER	REVISION		
	7/10/13	SS-1231-OS	B		