

NECK FINISH	BOTTLE WEIGHT (± 3 GR)	OVERFLOW CAPACITY (± 15 CC)	"T" DIA	"E" DIA	"H" DIM	"S" DIM	"I" DIA	MATERIAL
28-400	52.0	971.4	1.088 1.068	.994 .974	.465 .435	.061 .031	.987 MIN	HDPE
	60.0	963.0						

DATE	SYM	REVISION RECORD	AUTH	DR	CK
11/13/14	A	OVERFLOW CAP WAS 978 CC 3.310 DIA. WAS 3.325 DIA. ADJUSTED FILL LINES ADDED MOLD ID NO.			
12/17/14	B	REVISED TYPO FOR MATERIAL			KN

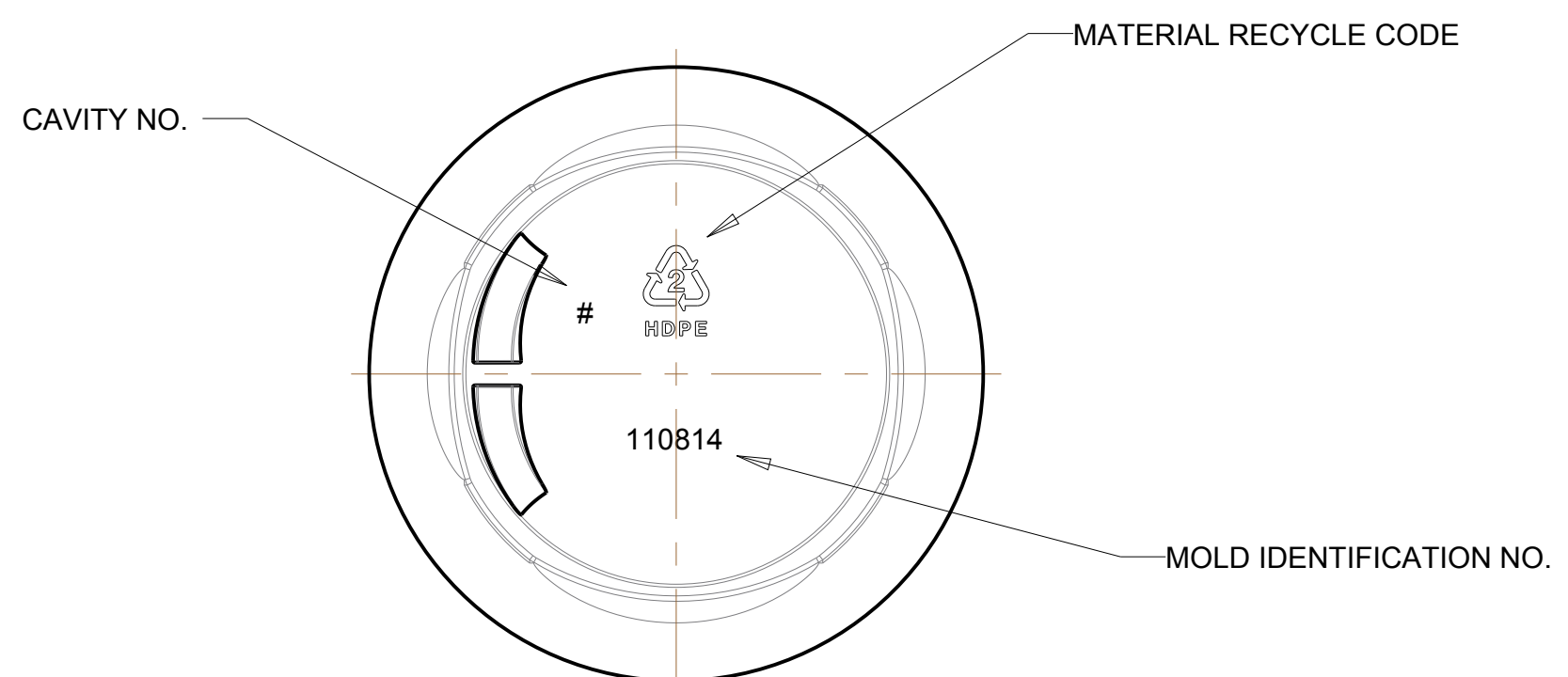
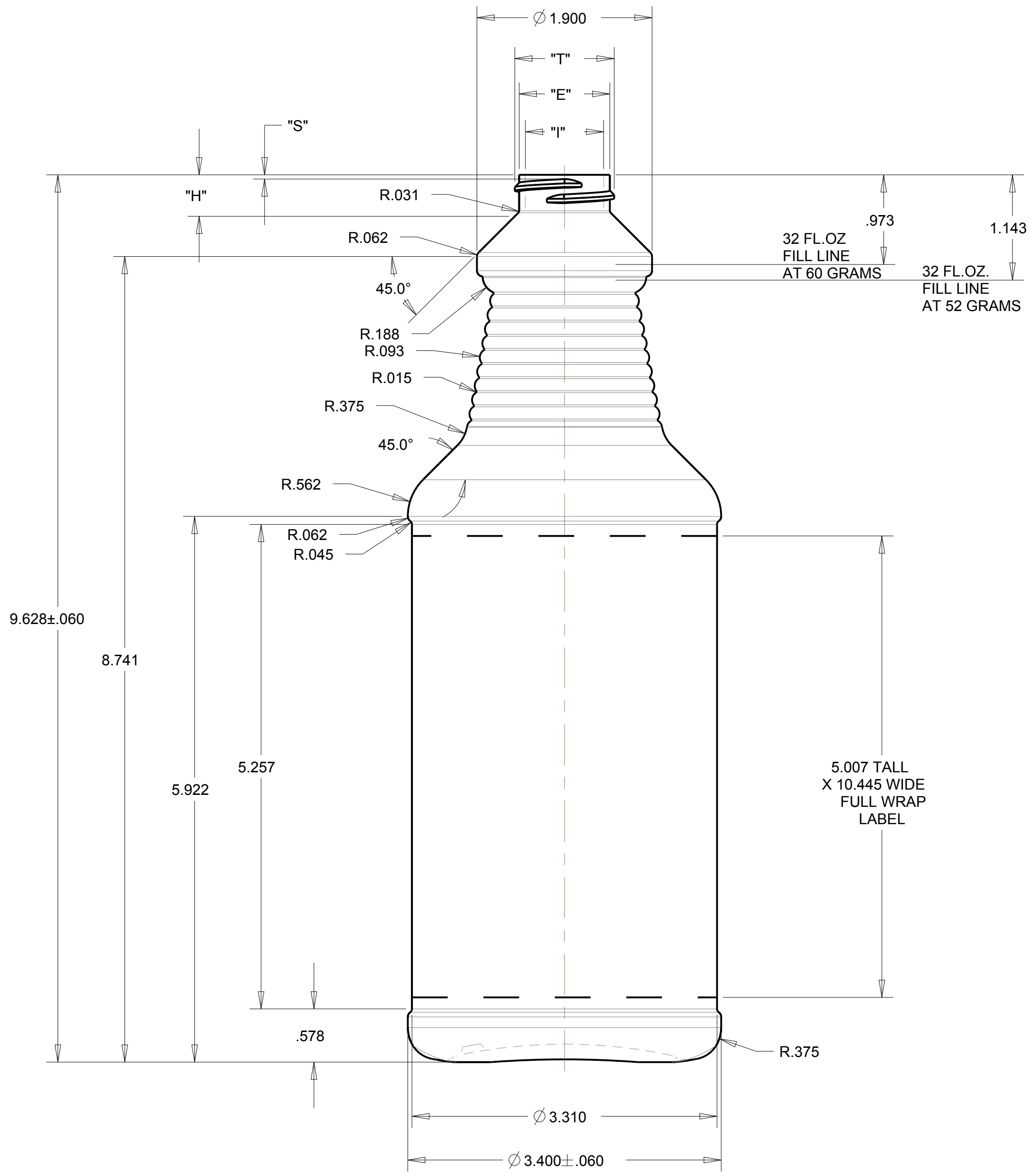
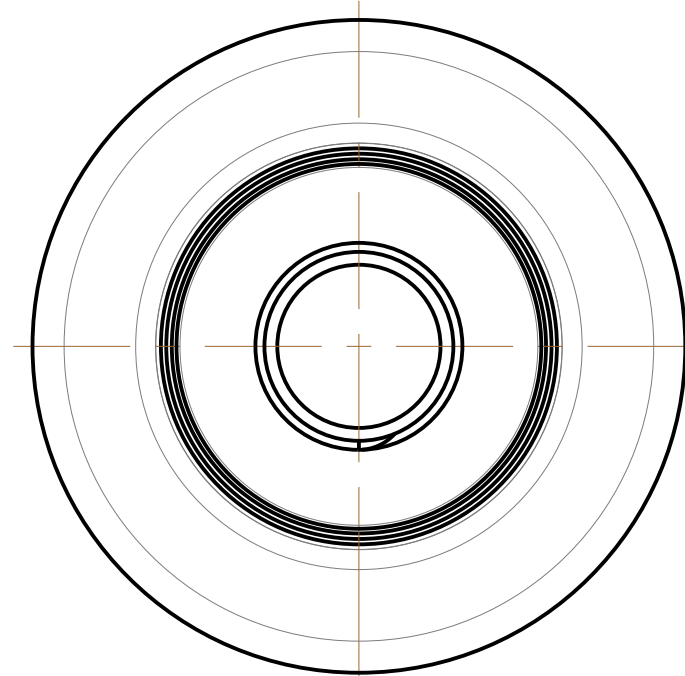

- NOTES:
- "M" STYLE THREAD  
PITCH - .167"  
ONE FULL TURN OF THREAD  
6 THREADS PER INCH
  - OVERFLOW CAPACITY IS BEFORE DECORATION.

TOLERANCES (EXCEPT AS NOTED)				
DECIMAL	MATERIAL	SCALE	DRAWN BY	
	HDPE	FULL	KSN	
FRACTIONAL	TITLE	APPROVED BY		MOLD NO.
	32 OZ CARAFE - 28-400			
ANGULAR	DATE	DRAWING NUMBER	REVISION	
	11/3/14	SS-1309-OS	B	

NECK FINISH	BOTTLE WEIGHT (± 3 GR)	OVERFLOW CAPACITY (± 15 CC)	"T" DIA	"E" DIA	"H" DIM	"S" DIM	"I" DIA	MATERIAL
28MM RATCHET	52.0	975.7	1.087 1.067	.991 .976	.747 .717	.085 .055	.861 REF.	HDPE
	60.0	967.3						

DATE	SYM	REVISION RECORD	AUTH	DR	CK
11/13/14	A	OVERFLOW CAP WAS 981.0 CC 3.310 DIA. WAS 3.325 DIA. ADJUSTED FILL LINES ADDED MOLD ID NO.			
12/17/14	B	REVISED MATERIAL TYPO			KN
2/8/16	C	REVISED NECK TO MATCH CALMAR DRWG			KN

NOTES:

- "M" STYLE THREAD  
PITCH - .167"  
1.5 FULL TURNS OF THREAD  
6 THREADS PER INCH
- OVERFLOW CAPACITY IS BEFORE DECORATION.
- NECK FINISH IS PER CALMAR DWG. NO. 3PB0071 FOR 28MM TRIGGERS

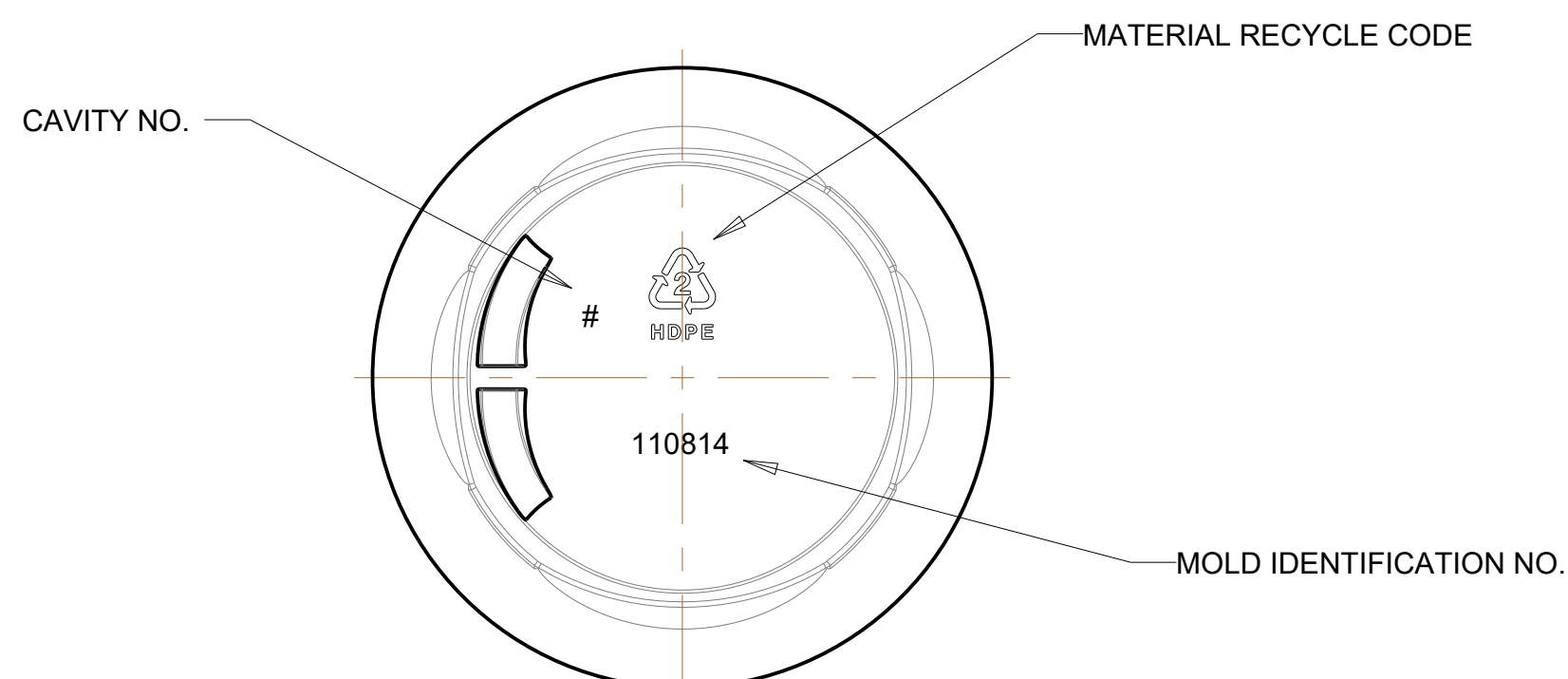
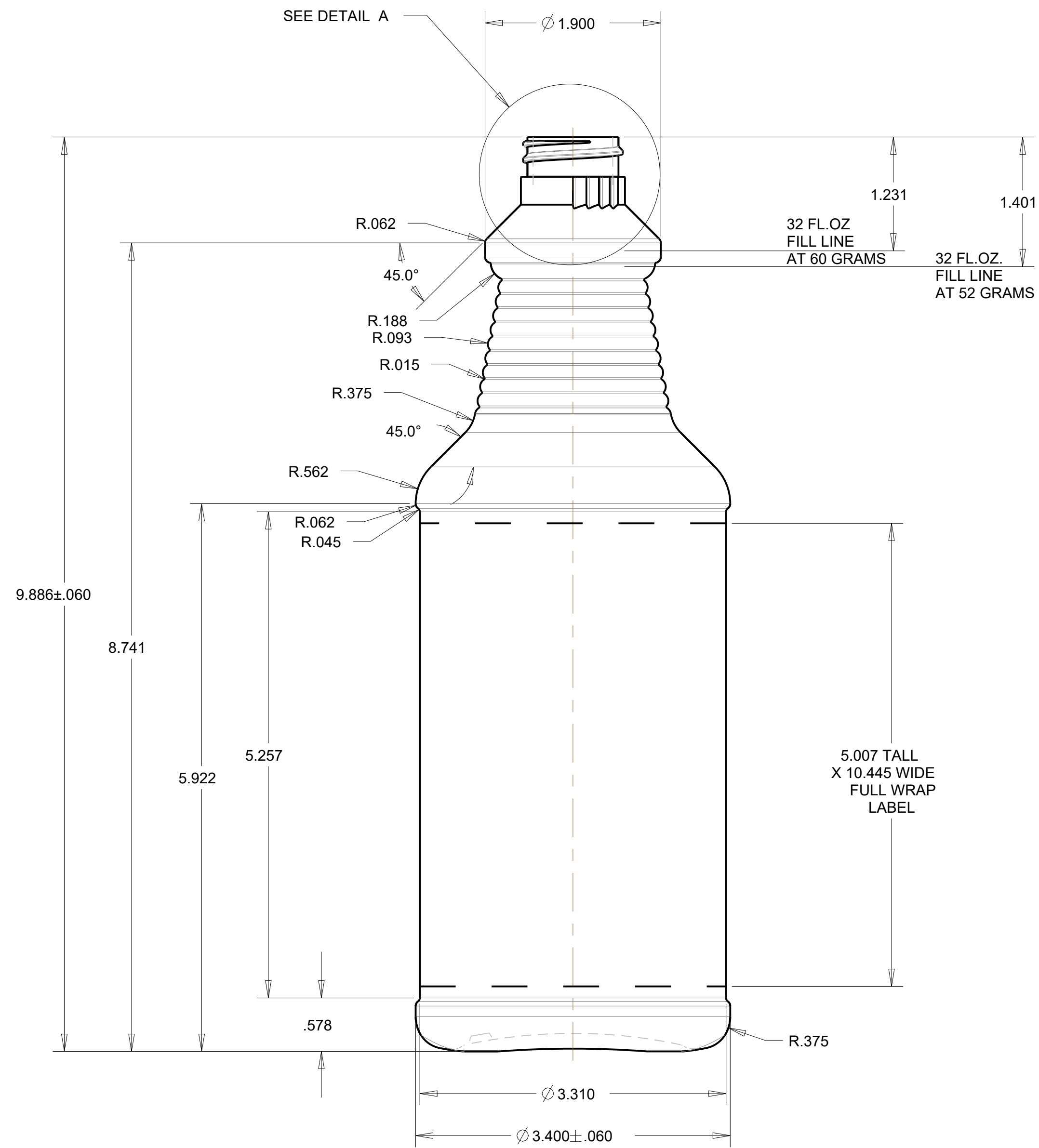
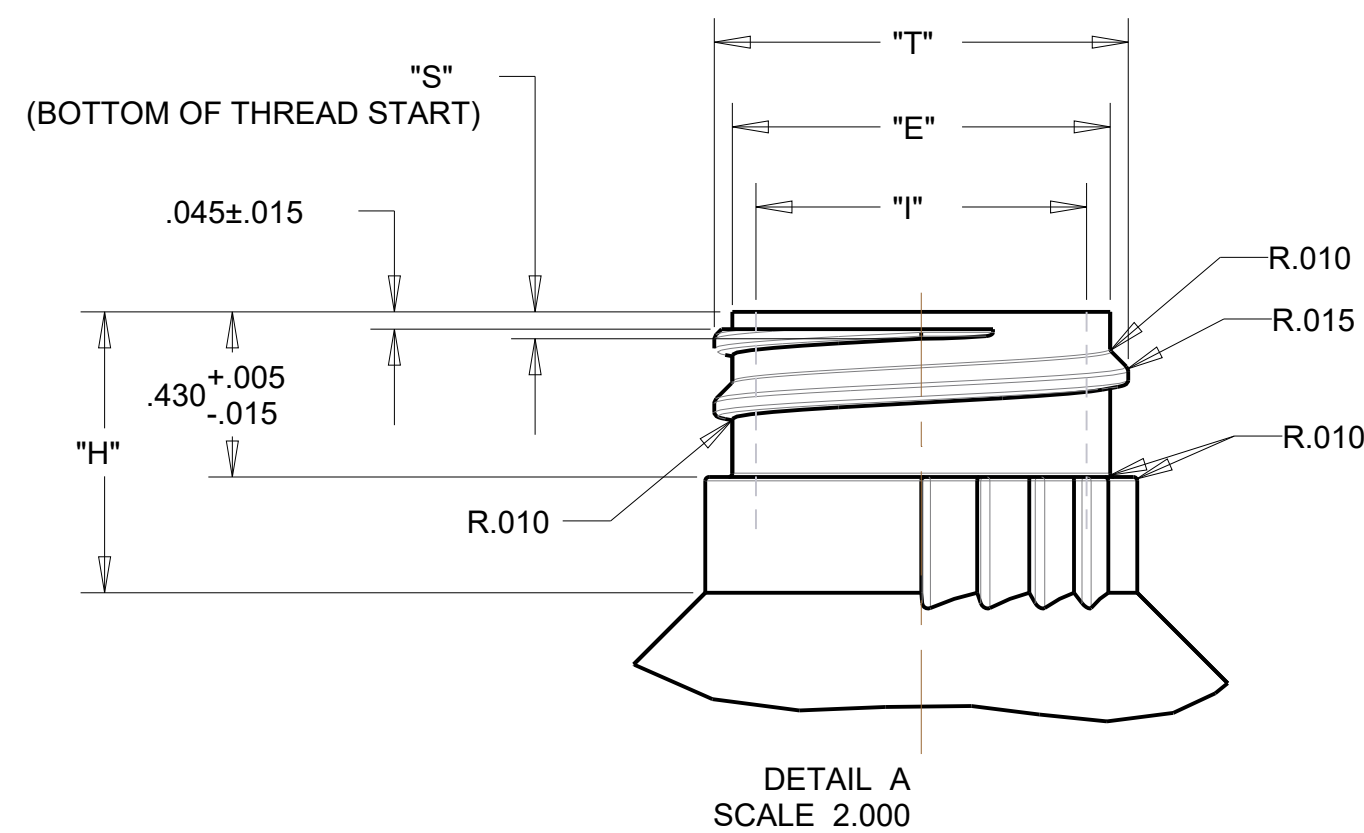
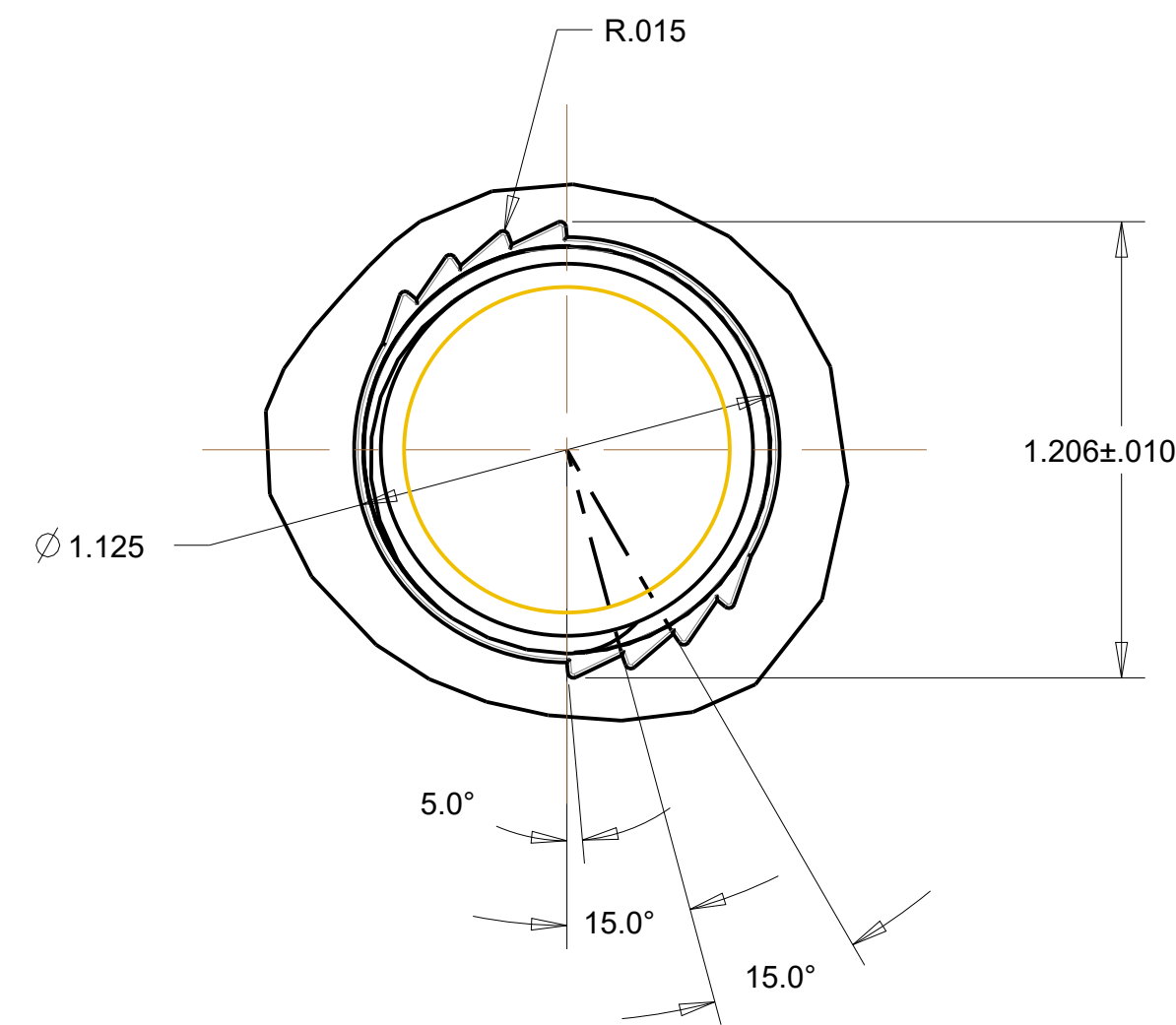

OCEAN STATE PACKAGING EXTRUSION AND INJECTION BLOW MOLDED BOTTLES				
TOLERANCES (EXCEPT AS NOTED)	MATERIAL	SCALE	DRAWN BY	
	HDPE	FULL	KSN	
FRACTIONAL	TITLE	APPROVED BY		MOLD NO.
	32 OZ CARAFE - 28MM RATCHET			
ANGULAR	DATE	DRAWING NUMBER	REVISION	
	11/3/14	SS-1311-OS	C	

NECK FINISH	BOTTLE WEIGHT (± 3 GR)	OVERFLOW CAPACITY (± 15 CC)	"T" DIA	"E" DIA	"H" DIM	"S" DIM	"I" DIA	MATERIAL
28-410	52.0	975.0	1.088 1.068	.994 .974	.723 .693	.061 .031	.987 MIN	HDPE
	60.0	966.6						

DATE	SYM	REVISION RECORD	AUTH	DR	CK
11/13/14	A	OFC WAS 479.8CC 3.310 DIA. WAS 3.325 DIA. ADJUSTED FILL LINES ADDED MOLD ID NO.			
12/17/14	B	REVISED MATERIAL TYPO			KN

NOTES:

- "M" STYLE THREAD  
PITCH - .167"  
1.5 FULL TURNS OF THREAD  
6 THREADS PER INCH
- OVERFLOW CAPACITY IS BEFORE DECORATION.

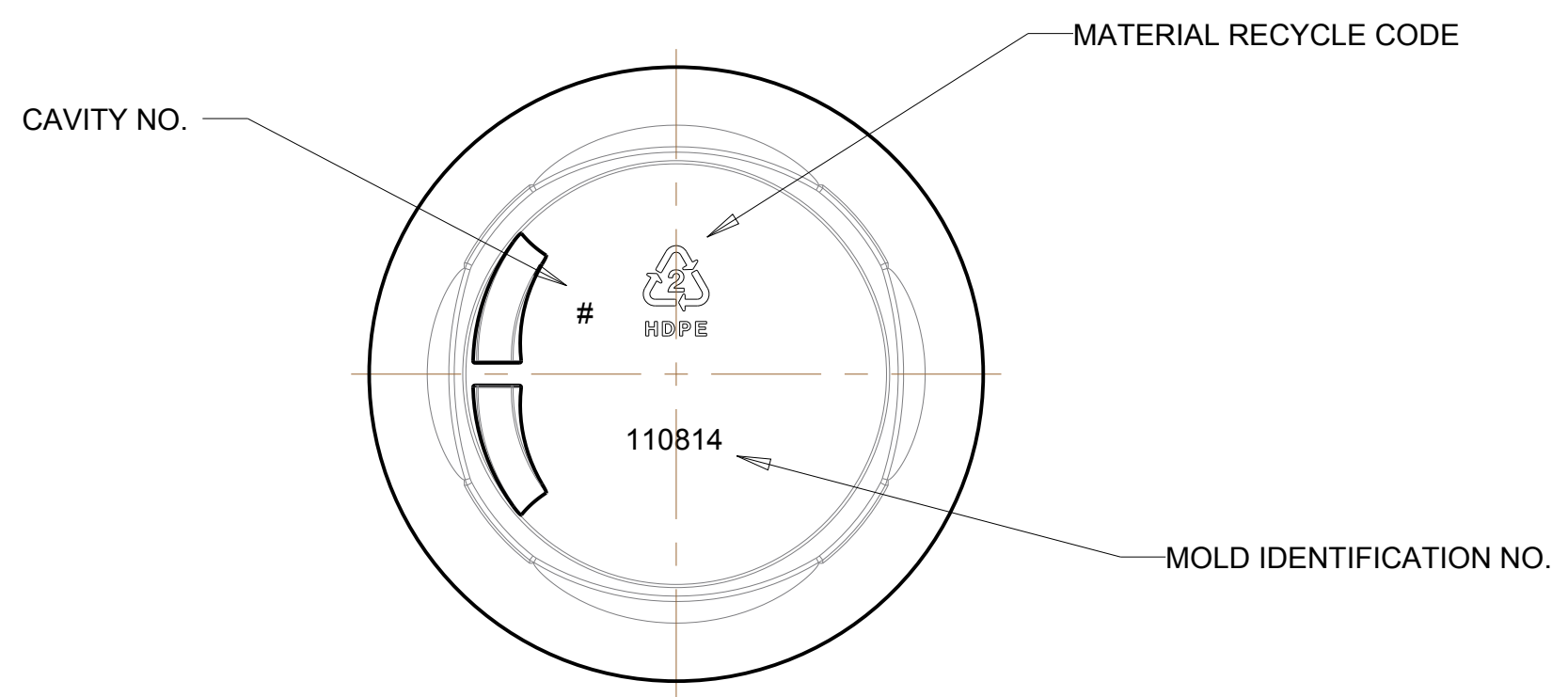
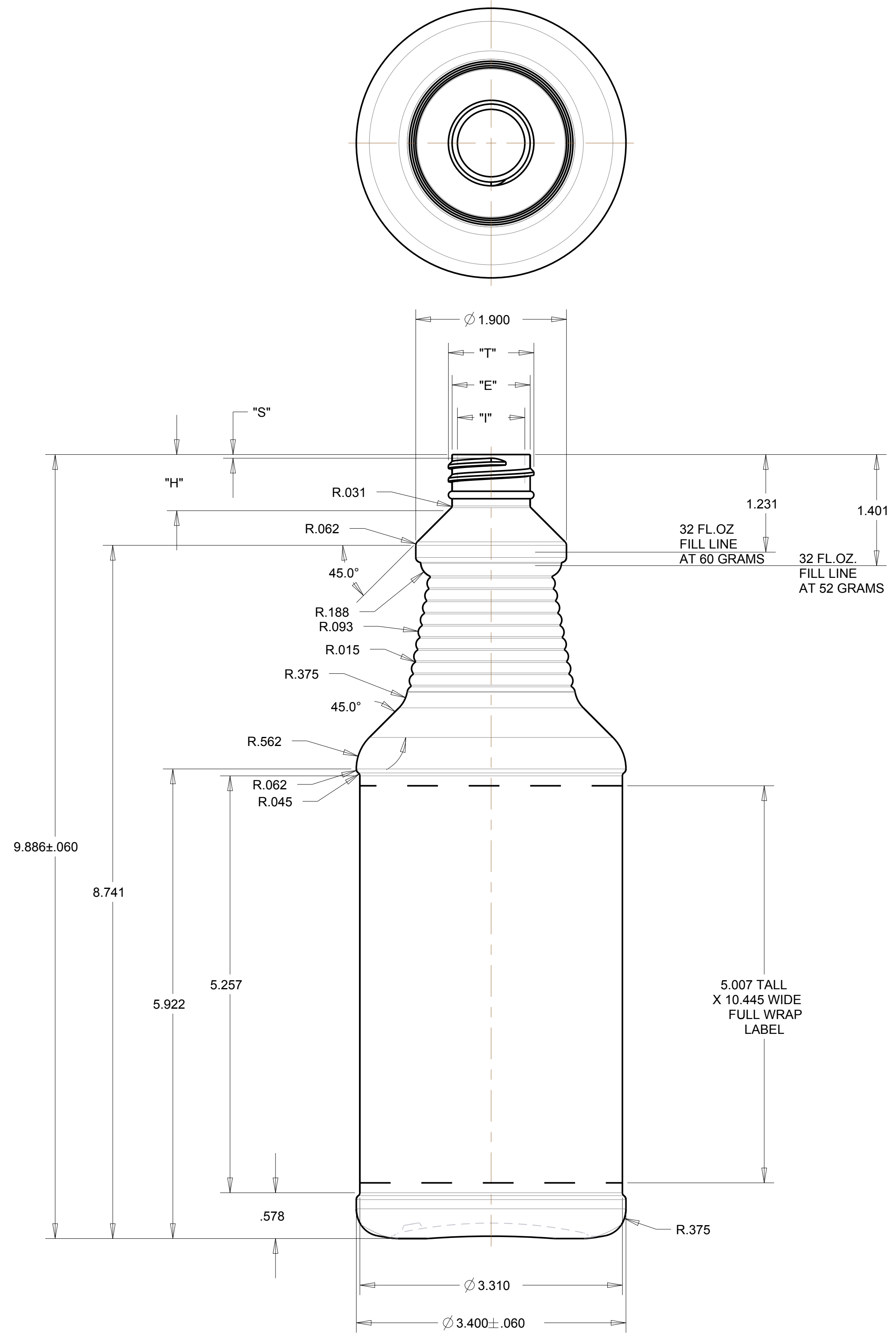

TOLERANCES (EXCEPT AS NOTED)				
DECIMAL	MATERIAL	SCALE	DRAWN BY	
	HDPE	FULL	KSN	
FRACTIONAL	TITLE	APPROVED BY		MOLD NO.
	32 OZ CARAFE - 28-410			
ANGULAR	DATE	DRAWING NUMBER	REVISION	
	11/3/14	SS-1310-OS	B	